

### 26.1 PARKING MAP: 2023

- Red lines = no bus pick up/drop off/parking/standing
- Blue Lines = bus pick up/drop off only (no all day parking)
- Green = car parking
- No Parking:  (indicated by a red dotted line)

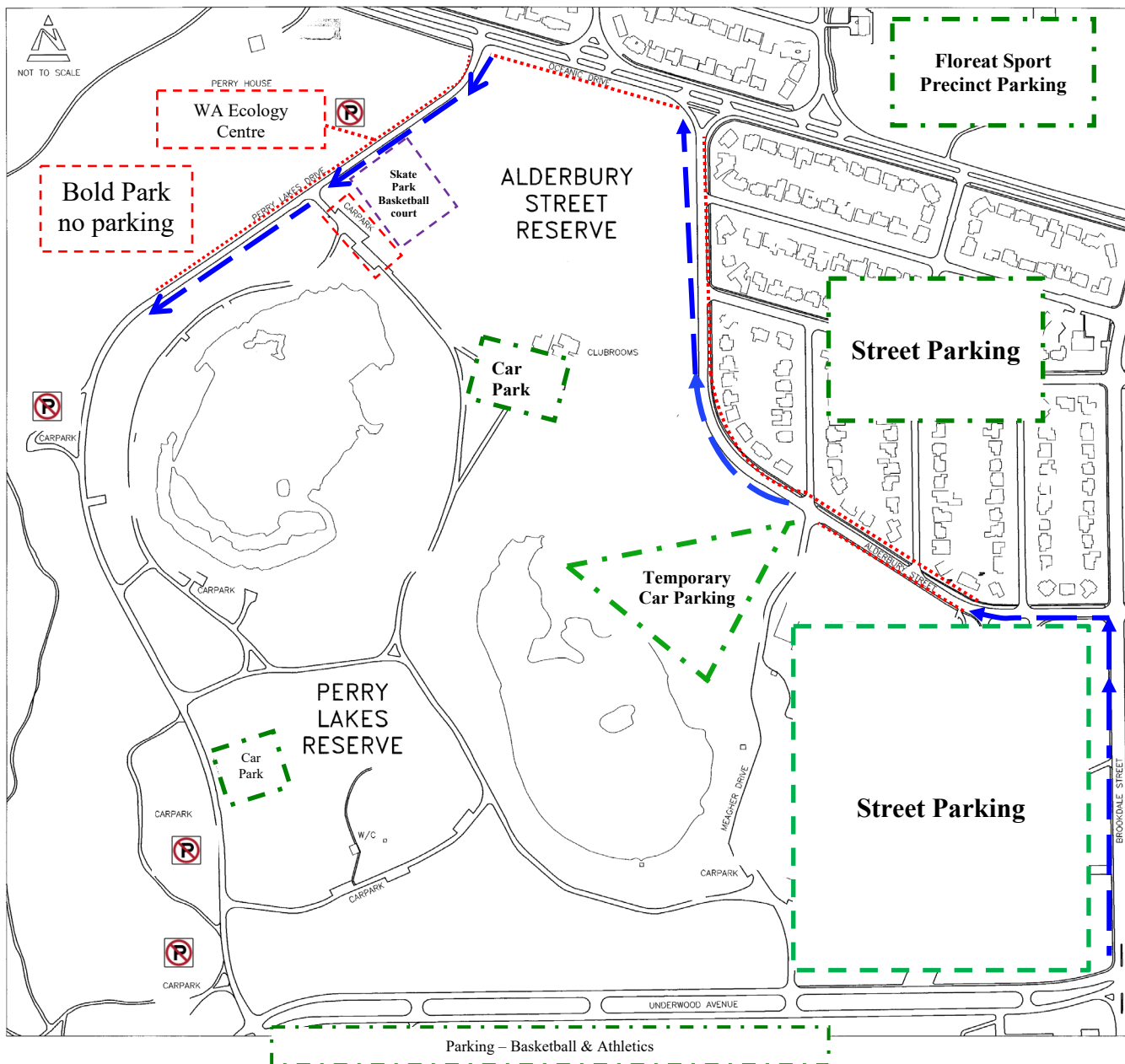

- **Large Buses:** are requested to drop off and pick up along Alderbury St (west side) or Perry Lakes Drive (east side). Schools A-L on Alderbury St and schools M-Z on Perry Lakes Drive. Large buses remaining for the duration of the event are to use the car parking at City Beach (between Challenger Parade and Fred Burton Way).
- **No** all day parking on Alderbury St, Perry Lakes Drive or Brookdale St. **No** bus parking behind YMCC hockey clubrooms and the temporary grass car park off Alderbury Street.

For more information about designated parking areas schools are asked to contact the chief ranger at the Town of Cambridge on: Direct – 9347 6031, Main switch – 9347 6000